

The Messenger Bag

New! Instructions for interfacing the “Messenger Bag” if you are using a light to mid weight Fabric.

Materials List

- 1 1/2 yards of a light to mid-weight cotton for the Exterior
- 1 1/2 yards of a coordinating light to mid-weight cotton for the Lining
- 1 1/2 yards of heavyweight sew-in Interfacing
- 1/4 yard of 3/4” Sew on Velcro™
- 1 large Button or Decorative Pin
- Chalk Pencil
- Ruler
- Turning Tool (*example: a closed pair of scissors*)

"The Messenger Bag"

ID # 008MB

NOTE: All seams are 1/2"

unless stated otherwise

(The 1/2" seam allowances are included on each pattern piece and in the measurements given.)

Follow the instructions on your printed instruction pages of the Rural Messenger Bag except replace the steps below with the new instructions for each of those steps.

Step 1. Follow the instruction on the printed instruction pages for the Messenger Bag.

Step 2. Replace the cutting guides on the instruction page with the cutting guides below.

CUT ALL OF THE MESSENGER BAG PARTS OUT OF THE EXTERIOR FABRIC, LINING AND INTERFACING

For the Exterior of the bag

- Cut 2 Messenger Bag Main Panels on the fold* - pattern piece enclosed
- Cut 2 Purse Main Panels – 10” wide x 9 1/2” long
- Cut 1 Side/Bottom Panel – 3” wide x 44 1/2” long
- Cut 2 Purse Flaps – pattern piece enclosed
- Cut 1 Outside Pocket Panel on the fold* – pattern piece provided
- Cut 2 Straps – 3” wide x 44 1/2” long

For the Lining of the bag

- Cut 2 Messenger Bag Main Panels on the fold*- pattern piece provided
- Cut 2 Purse Main Panels – 10” wide x 9 1/2” long
- Cut 1 Side/Bottom Panel – 3” wide x 44 1/2” long
- Cut 1 Outside Pocket Panel on the fold*– pattern piece provided

From the Interfacing

- Cut 2-Messenger Bag Main Panels on the fold* - pattern piece enclosed
- Cut 2-Purse Main Panels – 10” wide x 9 1/2” long
- Cut 1-Side/Bottom Panel – 3” wide x 44 1/2” long
- Cut 1-Purse Flap – pattern piece enclosed
- Cut 1 Outside Pocket Panel on the fold* – pattern piece provided
- Cut 1-Strap – 3” wide x 44 1/2” long

*To cut your fabric on the fold, lay your pattern piece with the edge to be placed on the fold, even with the folded edge of your fabric. Once this pattern piece is cut out of your fabric, open it up and it will make one full panel.

Step 2 1/2 - Additional instructions to attach the interfacing to the exterior panels.

PREPARE THE EXTERIOR PANELS, POCKET, FLAP AND STRAP

A. Attach the Interfacing to the Messenger Bag's Exterior Main Panels – Place the first Interfacing Main Panel onto the **WRONG** side of the first Exterior Main Panel and pin in place. Machine baste the Interfacing to the Exterior Main Panel by stitching a **1/4"** seam completely around the panel. Repeat this step to attach the other Interfacing Main Panel to the other Exterior Main Panel.

B. Attach the Interfacing to the Exterior Side/Bottom Panel – Repeat Step 2 1/2 A to attach the Interfacing to the Exterior Side/Bottom Panel.

C. Attach the Interfacing to the Outside Pocket, Purse Panels, Purse Flap and Straps– Repeat Step 2 1/2 A to attach the Interfacing to the Outside Pocket, both Purse Panels, Purse Flap and Strap.

All your Exterior pieces are interfaced, now you can begin assembling your bag. Below is Step 3A to clarify the placement of the Velcro on the Front Main Panel.

Step 3.

ATTACH THE SIDE/BOTTOM PANEL TO THE FRONT MESSENGER BAG MAIN PANEL

A. First, add the Female Velcro to the first (Front) Main Panel –On the **Right** side of the first Main Panel, measure 5 1/2” down from the top left raw edge and mark with your chalk pencil. Then, measure 5 1/2” down from the top right raw edge and make another mark. Using your ruler match up these two marks and draw a chalk guideline across the width of the panel.

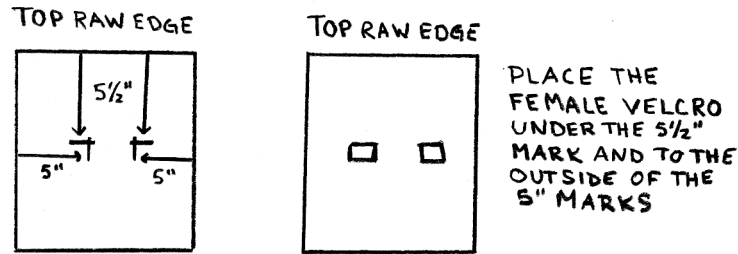

Then, on the chalk guideline measure 5" in from the left side raw edge and mark with your chalk pencil. Place a 1" piece of female Velcro under the 5 1/2" chalk guideline and to the outside (left) of the 5" mark and pin the Velcro in place. Attach the Velcro by stitching completely around the piece. Repeat this step to mark and attach a 1" piece of Velcro on the right side of the panel. This panel is your Front Messenger Bag Main Panel.

Follow Step 3B on the printed instruction page to attach the Side/Bottom Panel to the Front Main Panel.

Step 4.

MAKE AND ATTACH THE OUTSIDE POCKET TO THE MESSENGER BAG'S BACK MAIN PANEL

A. Attach the Outside Pocket Panel and the Lining together - Place the **RIGHT** sides of the interfaced Outside Pocket Panel and the Outside Pocket Lining together, match up the raw edges and pin in place. Stitch the panels together by stitching a 1/2" seam across the top raw edges of the panels.

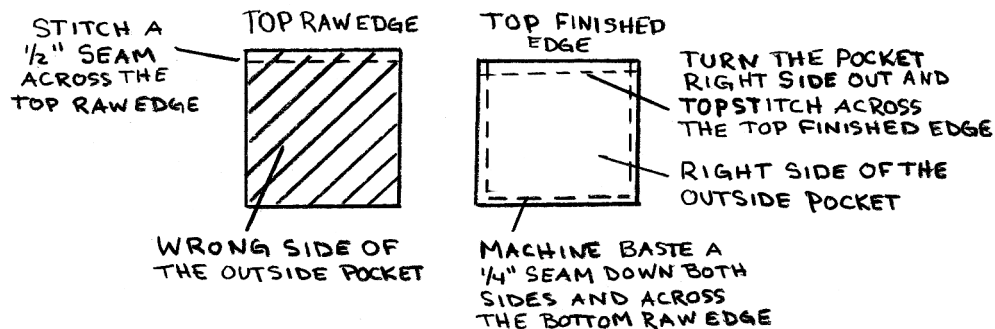

Turn the Pocket **RIGHT** side out and press. Topstitch with a 1/2" seam across the top finished edge of the pocket. Then, machine baste with a 1/4" seam down both sides and across the bottom of the pocket.

Continue with the instructions for Steps 4B through 7A on your printed instruction pages. Replace Steps 7A-7K with Steps 7A-7K2 below.

Step 7.

MAKE AND ATTACH THE PURSE AND FLAP TO THE MESSENGER BAG

A. Follow the instructions for Step 7A on your printed instruction page. You may have to replace the illustration on your printed instruction page if it is different than the illustration below. (When we printed our first Messenger Bag pattern we had the wrong illustration for Step 7A. The illustration below is the corrected illustration.)



PURSE FLAP

B. On the **RIGHT** side of the Flap Lining, measure 1 1/2" up from the bottom raw edge of the Flap on the center crease. Center a 1" piece of male Velcro™ over the crease and above the 1 1/2" mark and pin in place. Attach the Velcro™ by stitching completely around it, backstitching at each end.

C. Follow this step on your printed instruction pages.

D. Trim the corners of the Flap - With your scissors, trim each corner of the Flap in the seam allowance, making sure not to clip the stitching. Then, turn the Flap **RIGHT** side out, use a turning tool to push out the corners and press. Set the Flap aside for now.

MAKE THE PURSE SECTION

E. SKIP 7E and go onto Step 7F on your printed instruction pages.

F. Follow the instructions for Step 7F replacing the illustration with the illustration below

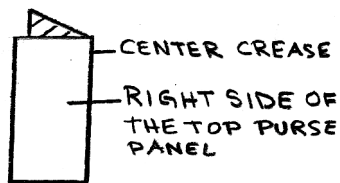

G. On the **RIGHT** side of the Top Purse Panel, measure 4" down on the center crease and make a mark with your chalk pencil. Center a 1" piece of female Velcro™ over the center crease and below the 4" mark. Pin the Velcro™ in place. Attach by stitching completely around the Velcro™, backstitching at each end. Set this piece aside for now.

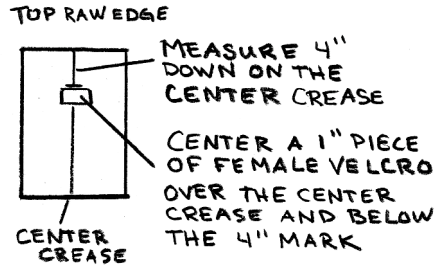

H. Follow Step 7H on your printed instruction page replacing the illustration with the illustration below.

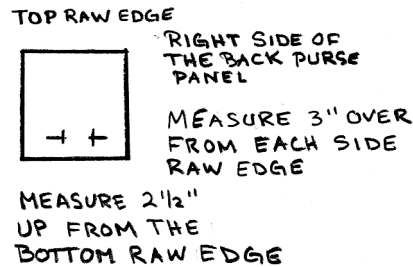

I. Add the male Velcro™ to the back Purse Panel - Starting on the left side of the back Purse Panel, take a 1" piece of male Velcro™ and place it above the 2 1/2" mark and to the outside (left) of the 3" mark. Pin the Velcro™ in place and attach by stitching completely around the piece. Repeat this step to place and attach another 1" piece of male Velcro™ on the right side of the Back Purse Panel.

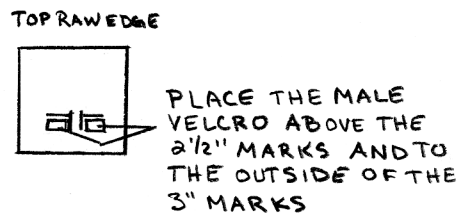

J. Attach the Purse Main Panels together- With **RIGHT** sides together, place the Top Purse Panel onto the Back Purse Panel matching up the raw edges. Starting on the right side of the panel, start and stop stitching a 1/2" from the top raw edge, stitch a 1/2" seam down both sides and across the bottom raw edges of the Purse, backstitching at each end.

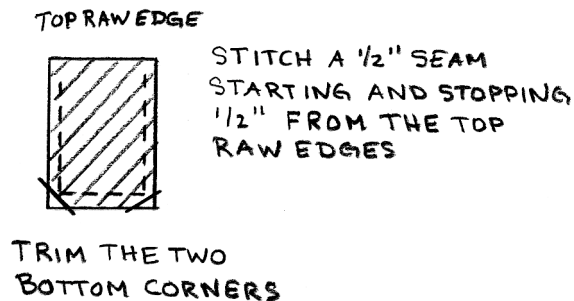

K. Trim the corners of the Purse - With your scissors, trim the two bottom corners in the seam allowance, making sure not to clip the stitching. Turn your purse **RIGHT** side out, using a turning tool to push out the corners and press.

Repeat Step 7J and 7K to make the lining for the Purse.

K1. Attach the Lining to the Exterior Purse - With the **RIGHT** side of the Exterior Purse facing out and the **WRONG** side of the Lining facing out, slip the Lining over the Exterior Purse and pin it in place. (The side of the Purse with the single piece of female Velcro™ is the Purse's front.) Attach the Purse to the Purse Lining by stitching a 1/2" seam across the front top raw edges. Start and stop stitching at the side seams, backstitching at each end.

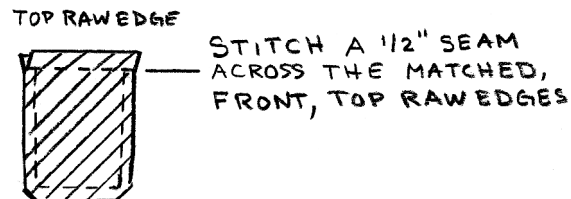

K2. Turn the Purse **RIGHT** side out, push the Lining down inside the Purse and press along the front top finished seam. Topstitch with a 1/2" seam across the front top finished seam of the Purse. Match up the top back raw edges and pin in place. Machine baste the Exterior Purse to the Lining by stitching a 1/4" seam across the matched top raw edges.

TURN THE PURSE RIGHT SIDE OUT

TOPSTITCH ACROSS THE FRONT TOP FINISHED EDGE

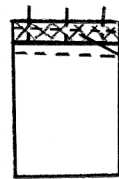

TOP RAW EDGE

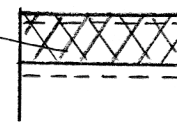

Continue on with Step 7L and 7M on the printed instruction page. Then replace Steps 8A and 8B with Steps 8A and 8B below.

Step 8. To add clarity for the placement of the Velcro™, follow these next steps.

SEW THE LINING PANELS

A. First, on the **RIGHT** side of the Messenger Bag's Front Lining Panel, measure 1 1/2" down from the left side top raw edge and make a mark. Then, measure 2 1/2" in from the left side raw edge and make another mark. Cut a 1 1/2" piece of male Velcro™ and place it on the front Lining Panel below the 1 1/2" mark and to the inside of the 2 1/2" mark. Pin the Velcro™ in place and attach by stitching completely around it, backstitching at each end. Repeat this step to cut and attach another 1 1/2" piece of male Velcro™ to the right side of the Front Lining Panel.

B. Repeat Step 8A to cut and attach a 1 1/2" piece of female Velcro to the Back Lining Panel.

Continue on with Step 8C through Step 9E on the printed instruction page to finish your Messenger Bag.

Glossary - for the Rural Messenger Bag

-Female Velcro™ - The fuzzy nap side of the Velcro™.

-Male Velcro™ – The pointy, prickly side of the Velcro™.

-Interfacing – A stiffening fabric-like material used to give your project strength and durability. Interfacing also gives lighter weight fabrics stiffness and body.

-Machine baste – A machine baste stitch is used to hold sections of your project in place until you are ready to complete your final stitches. Use the longest stitch length on your machine. You do not have to backstitch at each end of your stitching.

-Turning tool – A pointed tool that can be used to push the corners out on your project.
Example - A closed pair of scissors.